

# AUTOMATE | FT MOTOR INSTRUCTIONS



AUTOMATE | FT MOTOR [Ø45/15Nm/15rpm]  
P/N: RB24-6005-069005

## DESCRIPTION

AUTOMATE | FT MOTOR is a multifunction tubular motor offering three different modes of operation;

- E-type for standard use,
- MANUAL FT Mode for use with conventional locking devices with fabric tensioning,
- AUTO FT Mode for use with Rollease Acmeda's proprietary ULTRA LOCK providing automatic fabric tensioning.

Activating fabric tension (FT) mode delivers a choice of 3 distinct tensioning levels to suit a wide range of sizes and external applications.

Functional options in each operating mode include; IMPACT DETECTION & FAVOURITE POSITION.

Impact detection senses an obstacle in the blinds path and redirects the blind to protect the motor, hardware and fabric, ensuring product longevity.

An intermediate setting allows for a customised favorite position to be pre-set.

## FUNCTIONS

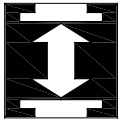

**ELECTRONIC  
LIMIT SWITCH**



**BRAKE**

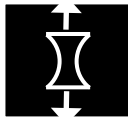

**FABRIC  
TENSION**



**ULTRA-LOCK**



**FAVORITE  
POSITION**

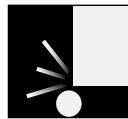

**IMPACT  
DETECTION**

TECHNICAL SPECIFICATIONS	
Rated Torque	15Nm
Fabric Tension Torque	[Electronically Selectable 5Nm / 10Nm / 15Nm]
Rated speed	15rpm
RF receiver	433.92MHz
Protection class	IP44
Rated Voltage	220 - 240V AC
Frequency	50Hz
Motor Weight	1.98Kg
Rated current	140W
Rated power	0.61A
Motor diameter	45mm
Max Running Time	4 min



# CONTENTS

---

1. Compatible Controllers	p2
2. Installation	p3
2.1 WARNING: Important Safety instructions to be read before installations	p3
2.2 Assembly	p4
2.3 Wiring Diagram	p4
3. Programming & Use	p4
3.1 Warning: Important safety instructions to be read prior to operation	p4
3.2 Overview of P2 function – How to activate setting mode	p5
3.3 Overview of operational modes	p5
3.4 Pairing motor to transmitter	p6
3.5 Setting top & bottom limits	p7
3.6 Set Favourite position	p8
3.7 Impact Detection	p9
3.8 Copy Channel from an existing primary transmitter	p9
3.9 Activate / Deactivate Fabric Tension Mode	p10
3.10 Switch between Auto & Manual Lock Mode	p10
3.11 Adjusting Tension Level	p10
4. Troubleshooting	p11

# COMPATIBLE CONTROLLERS

---

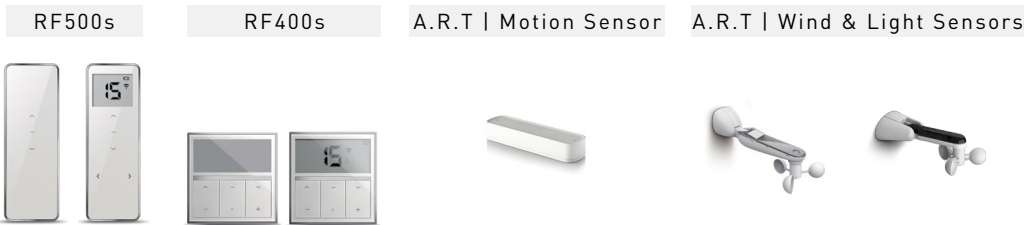

## 2. INSTALLATION

---

### 2.1 WARNING: Important safety instructions to be read before installation.

---



Incorrect installation can lead to serious injury and will void manufacturer's liability and warranty.

- Installation and programming to be performed by a suitably qualified installer.
- For use within tubular blinds & awnings.
- Ensure correct crown and drive adaptors are used for the intended system.
- Use only Rollease Acmeda hardware.
- Before installation, remove any unnecessary cords and disable any equipment not needed for powered operation.
- Ensure torque and operating time is compatible with end application.
- Do not expose the motor to water or install in humid or damp environments.
- Tube and the drive adaptor should be evenly fixed with 4 pieces of 4x10 countersunk self-tapping screws. Ensure screw tip does not penetrate through the internal surface of the drive.
- Motor is to be installed in horizontal application only.
- Do not drill into motor body.
- For awning installation, a horizontal distance of at least 0,4m is to be maintained between the fully unrolled driven part and any obstacle.
- Ensure at least one control point is located within direct sight of unit but away from any moving parts.
- The routing of cable through walls shall be protected by isolating bushes or grommets.
- Ensure power cable and aerial is clear and protected from moving parts.
- Power supply cables are not be exposed to sunlight and must be protected by U.V resistant conduit.
- Ensure power is isolated prior to connecting or disconnecting inline connector.
- If cable or inline connector is damaged do not use.

## 2.2 ASSEMBLY

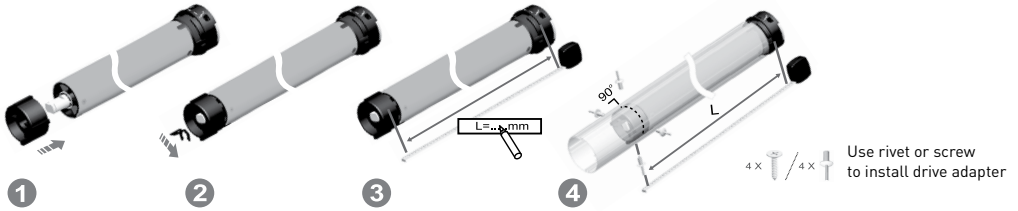

Please refer to Rollease Acmeda System Assembly Manual for full assembly instructions relevant to the hardware system being used.

1. Install specified crown & drive adaptor for selected tube.
2. Ensure drive retainer clip is securely in place.
3. Measure distance from end of crown/tube to the centre of drive.
4. Insert motor into tube

### NOTE:

- Use a file to ensure tube is free of burrs.
- Use 4 x rivets or screws to fix drive adaptor to tube.
- Ensure screw tips do not penetrate through the internal surface of drive

## 2.3 WIRING

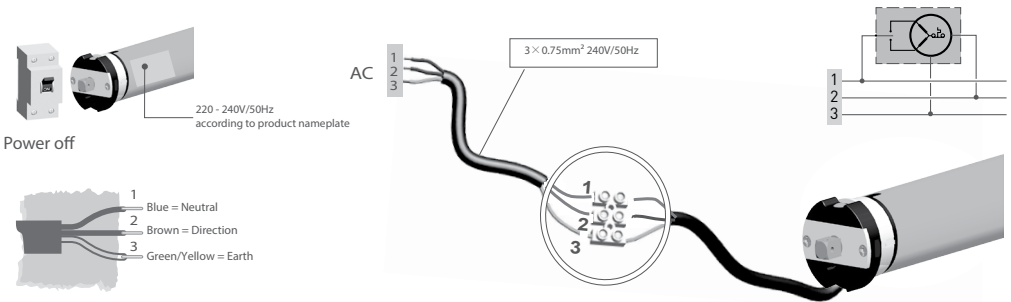

## 3. PROGRAMMING & USE

### 3.1 WARNING: Important safety instructions to be read prior to operation.

It is important for the safety of persons to follow these instructions. Save these instructions for future reference.

- Persons (including children) with reduced physical, sensory or mental capabilities, or lack of experience and knowledge should not be allowed to use this product.
- Keep remote controls away from children.
- Frequently inspect for improper operation. Do not use if repair or adjustment is necessary.
- Keep motor away from acid and alkali.
- Do not force the motor drive.
- Keep clear when in operation.
- This unit has a thermal cut-off switch. The rated operating time is 4 minutes. Unit will restart once it cools down.
- Isolate power prior to unplugging connector, performing maintenance or window cleaning.
- Avoid operation if frost or ice has formed on motorized unit.

### 3.2 OVERVIEW OF P2 FUNCTION

Below is an overview of how to activate the P2 function on your chosen primary controller.

RF500s



Press P2

RF400s



Single Channel / Timer

P2 = zero & CH (+)



Fifteen Channel

P2 = zero

### 3.3 OVERVIEW OF OPERATIONAL MODES

#### 3 SELECTABLE MODES

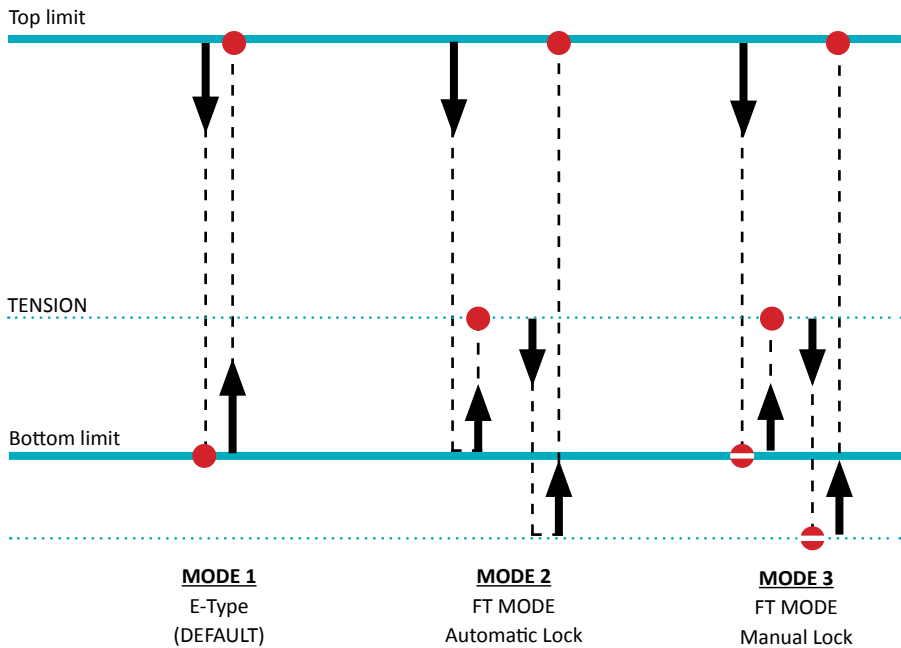

#### LEGEND

● END OF CYCLE

◕ CYCLE PAUSE

### 3.4 PAIRING MOTOR TO TRANSMITTER

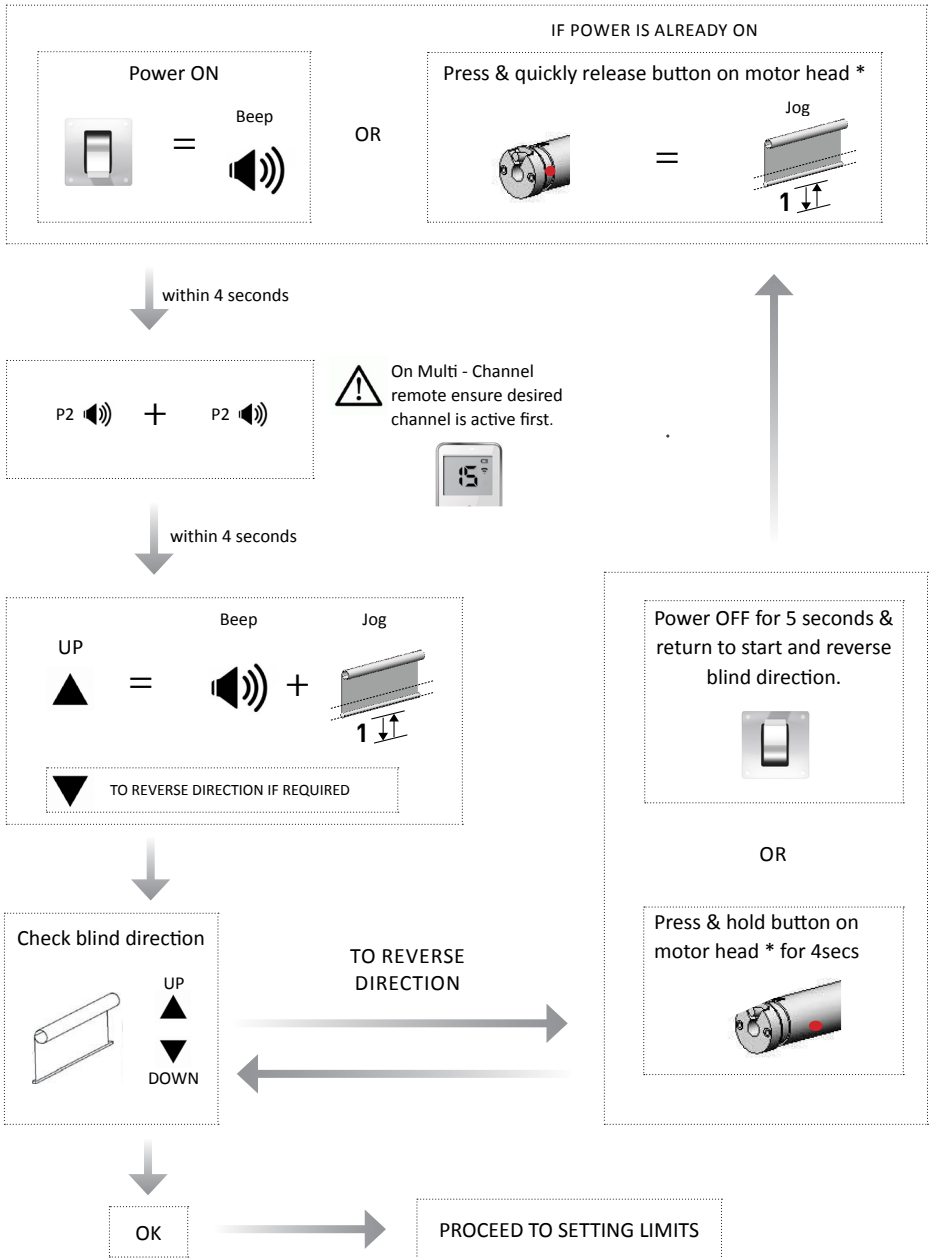

**!** Cutting power before limit setting process is complete will result in loss of pairing.  
To reset motor P2 + STOP + P2. Removes all emitters & deletes limits.

### 3.5 SETTING TOP & BOTTOM LIMIT

#### ENTER LIMIT SETTING MODE



Please cycle blind up and down to settle fabric prior to setting limits

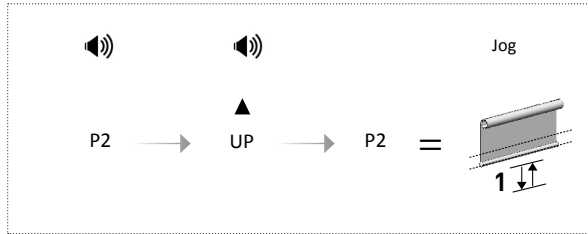

#### SET TOP LIMIT

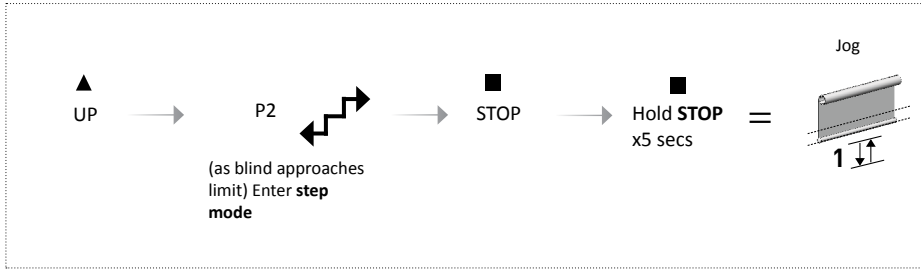

#### SET BOTTOM LIMIT

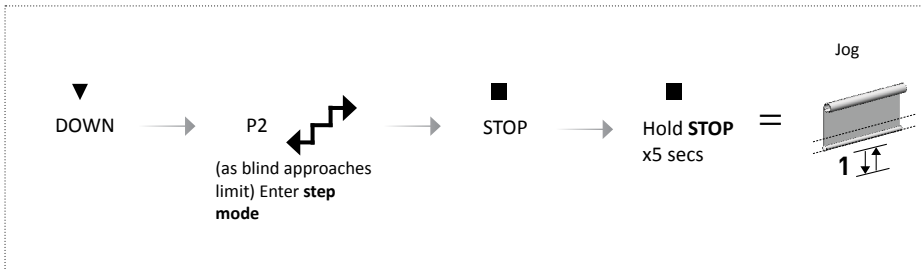

If pairing multiple motors to a single channel ensure power is switched off prior to proceeding to the next motor.  
Cycle blind up and down first to settle fabric prior to setting limits

### 3.6 FAVORITE POSITION

#### SETTING FAVORITE POSITION

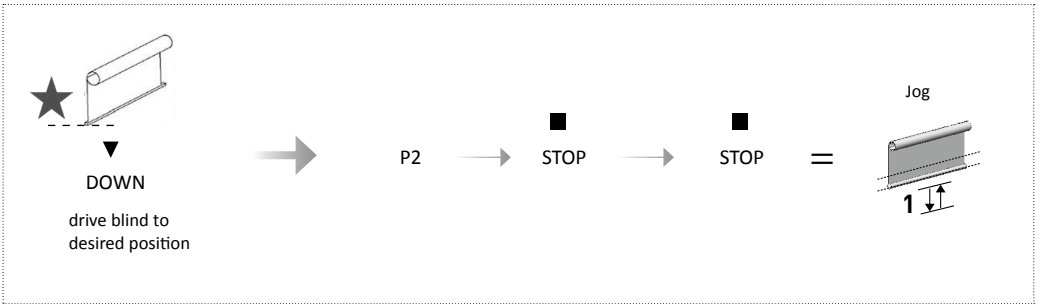

#### DELETING FAVORITE POSITION



Blind can be at any point.

#### TO SEND BLIND TO FAVORITE POSITION





### 3.7 IMPACT DETECTION

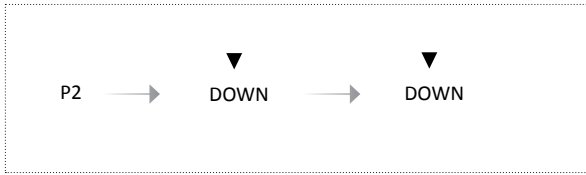

Beep  x 1 = ON

Beep  x 2 = OFF

### 3.8. COPY CHANNEL FROM AN EXISTING PRIMARY TRANSMITTER



On primary & secondary multi - channel remotes ensure desired channel is active first.

### 3.9 ACTIVATE / DEACTIVATE FABRIC TENSION MODE

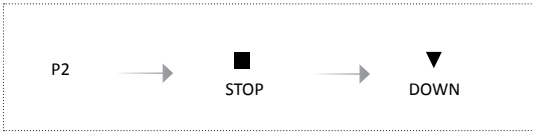

Beep  x 1 = TENSION MODE ON

Beep  x 2 = TENSION MODE OFF

### 3.10 SWITCHING BETWEEN AUTO & MANUAL LOCK MODE

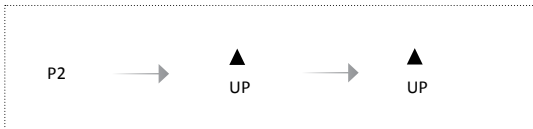

Beep  x 2 = AUTO LOCK

Beep  x 5 = MANUAL LOCK



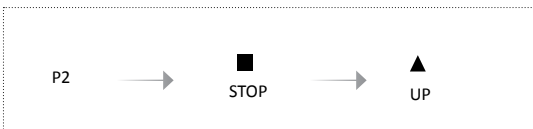

Fabric Tension Mode must be ON to switch between Auto & Manual Lock Mode

### 3.11 ADJUSTING TENSION LEVEL



Beep  x 1 = LOW

Beep  x 2 = MEDIUM

Beep  x 3 = HIGH

## 4. TROUBLESHOOTING

PROBLEM	CAUSE	REMEDY
Shade moves in opposite direction	Pairing sequence error.	refer to section 3.4 to reverse blind direction.
When power is switched on, the motor refuses to work or moves slowly	<ol style="list-style-type: none"> <li>1. Voltage too low</li> <li>2. Errors in line connection</li> <li>3. Overload</li> <li>4. Installation error.</li> <li>5. Transmitter batteries are Flat</li> </ol>	<ol style="list-style-type: none"> <li>1. Check voltage is within the rating specified.</li> <li>2. Check the wiring.</li> <li>3. Verify motor capacity (torque) has not been exceeded.</li> <li>4. Check for excessive friction in assembly. Ensure tube deductions are correct and that there is suitable clearance between motor head &amp; bracket.</li> <li>5. Replace batteries in transmitter.</li> </ol>
Motor suddenly cuts off.	Rated operating time (4min) exceeded	Wait approximately 20 minutes for motor to cool down.



How to delete all transmitters & limits. P2 + STOP + P2.

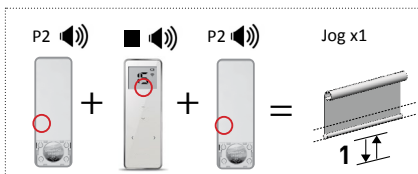

ROLLEASE ACMEDA  
AUSTRALIA

110 Northcorp Boulevard,  
Broadmeadows VIC 3047

T +61 3 9355 0100 | F +61 3 9355 0110

Western Australia Branch  
Unit 1, 41 Mulgul Road,  
Malaga WA 6090

T +61 8 9248 5571 | F +61 8 9248 5572

Queensland Branch  
Unit 2/62 Borthwick Avenue,  
Murarrie QLD 4172

---

ROLLEASE ACMEDA  
USA

200 Harvard Avenue  
Stamford, CT 06902 6320

T +1 203 964 1573 | F +1 203 964 0513

---

ROLLEASE ACMEDA  
EUROPE

Via Conca Del Naviglio 18, Milan  
(Lombardia) Italy

T +39 02 8982 7317 | F +39 02 8982 7317

---

[info@rolleaseacmeda.com](mailto:info@rolleaseacmeda.com)  
[rolleaseacmeda.com](http://rolleaseacmeda.com)