

AUTOMATE RF415s REMOTE INSTRUCTIONS

RF415s Fifteen Channel Remote Control

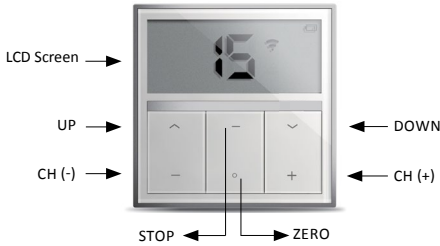

P/N: RB24-9015-069015



DESCRIPTION

433MHz wall mounted controller compatible with AUTOMATE “EL” motor range. Fifteen channel with a large LCD display. Hidden inactive channel feature. Slimline magnetic wall mount.

CONTENTS

- Wall mount transmitter
- Magnetic holder & fixing screws
- Instruction Manual
- 3V - CR2430 Battery

TECHNICAL SPECIFICATIONS	
Voltage:	3V (CR2430)
Frequency:	433.92 MHz
Transmitting Power:	10 milliwatt
Operating Temperature:	-5°C - 50°C
Transmission Distance:	up to 200 meters (open space)



INSTR.RB24-9015-069015_AUGUST 2015 v1.1

CONTENTS

Pair RF415s wall controller to EL motor	p3
Setting top & bottom limits to EL motor	p4
Setting number of active channels	p5
Copy channels from an existing primary transmitter	p6
Troubleshooting	p7

CAUTION

Do not expose to moisture or extreme temperatures
Replace with correct battery type as specified
Do not allow children to play with this device or battery.
Use or modification outside the scope of this instruction manual will void warranty.

DISPOSAL



Do not dispose of in general waste. Please recycle batteries and damaged electrical products appropriately

PAIR RF415s WALL CONTROLLER TO EL MOTOR

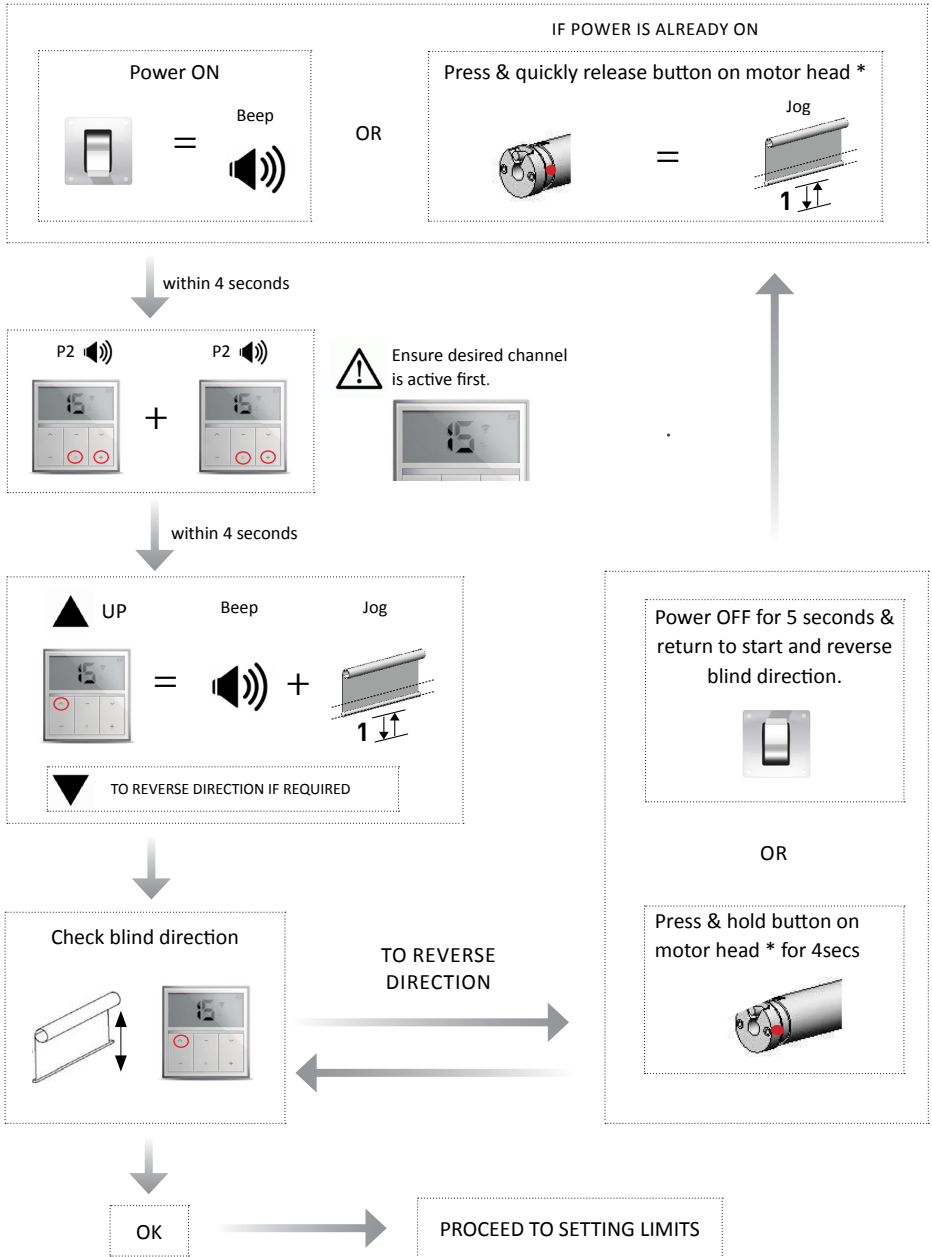



Cutting power before limit setting process is complete will result in loss of pairing.

To reset motor P2 + STOP + P2. Removes all emitters & deletes limits.

SETTING TOP & BOTTOM LIMITS TO AUTOMATE EL MOTOR

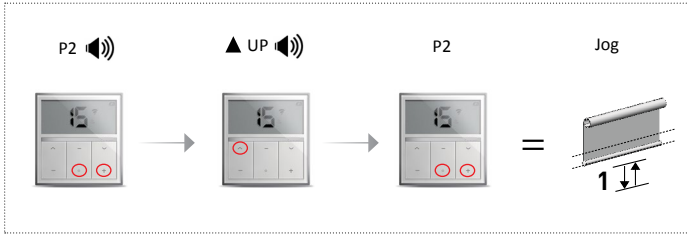
ENTER LIMIT SETTING MODE



 Please cycle blind up and down to settle fabric prior to setting limits

SET TOP LIMIT

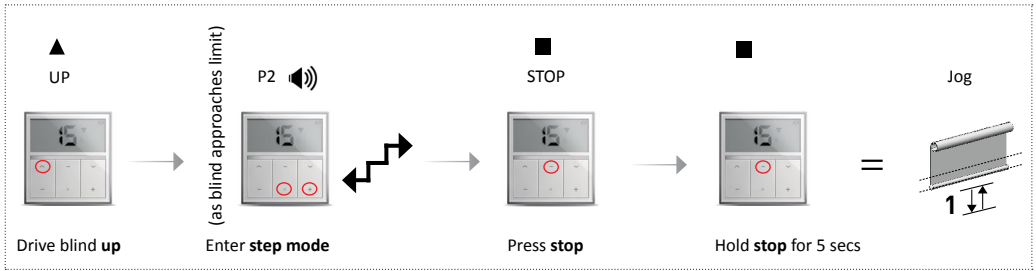

SET BOTTOM LIMIT

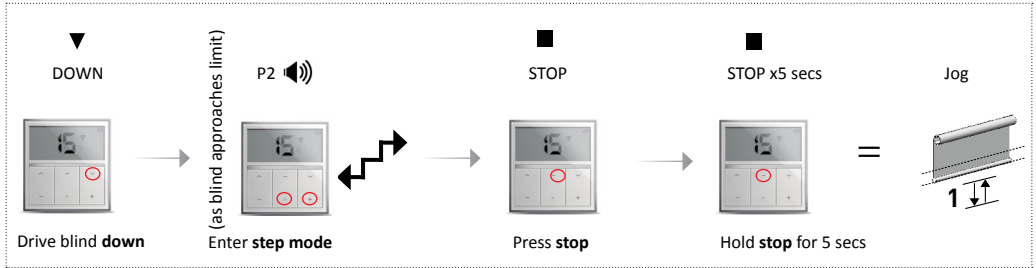

If pairing multiple motors to a single channel ensure power is switched off prior to proceeding to the next motor.
Cycle blind up and down first to settle fabric prior to setting limits

SETTING NUMBER OF ACTIVE CHANNELS

ENTER CHANNEL SELECTION MODE

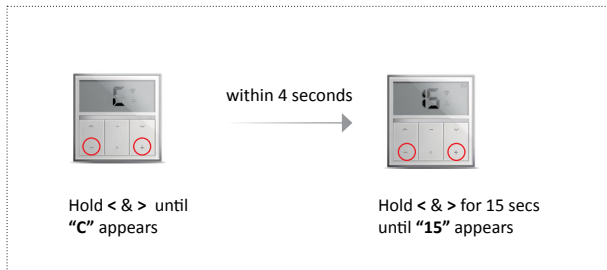

SELECT DESIRED CHANNEL RANGE

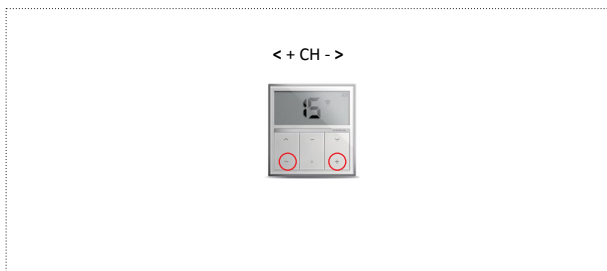

CONFIRM

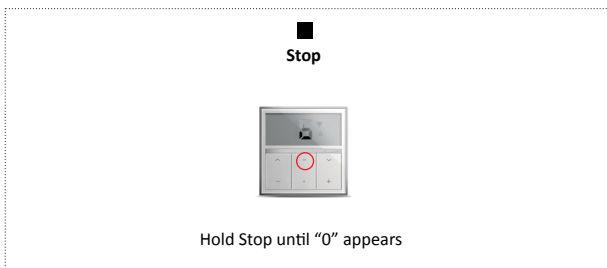

COPY CHANNEL FROM AN EXISTING PRIMARY TRANSMITTER.

ON PRIMARY TRANSMITTER

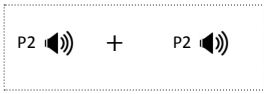

ON NEW TRANSMITTER



=

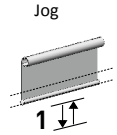

On primary & secondary multi - channel remotes ensure desired channel is active first.

HOW TO ACTIVATE P2 FUNCTION

RF500s



Press P2

RF400s



P2 = zero & CH (+)

TROUBLESHOOTING

PROBLEM	CAUSE	REMEDY
Motor is not responding	Transmitter battery is discharged	Replace battery
	Battery is inserted incorrectly	Check battery polarity
	Radio interference / Shielding	Ensure transmitter is positioned away from metal objects and that aerial on motor or receiver is kept straight and away from metal.
	Receiver distance is too far from transmitter	Move transmitter to a closer position.
	Power failure	Check power supply to motor is connected and active.
	Incorrect wiring	Check wiring is connected correctly (refer to motor installation instructions)



How to delete all transmitters & limits. P2 + STOP + P2.

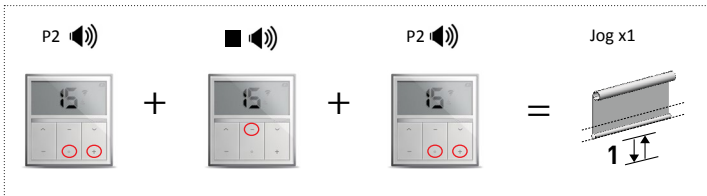

ROLLEASE ACMEDA

AUSTRALIA

110 Northcorp Boulevard,
Broadmeadows VIC 3047

T +61 3 9355 0100 | F +61 3 9355 0110

Western Australia Branch

Unit 1, 41 Mulgool Road,
Malaga WA 6090

T +61 8 9248 5571 | F +61 8 9248 5572

Queensland Branch

Unit 2/62 Borthwick Avenue,
Murarrie QLD 4172

ROLLEASE ACMEDA

USA

200 Harvard Avenue
Stamford, CT 06902 6320

T +1 203 964 1573 | F +1 203 964 0513

ROLLEASE ACMEDA

EUROPE

Via Conca Del Naviglio 18, Milan
(Lombardia) Italy

T +39 02 8982 7317 | F +39 02 8982 7317

info@rolleaseacmeda.com

rolleaseacmeda.com