

R-Series 0.2Nm | 18mm | 12V

The motorized R-Series roller shade system offers two Automate motors for two tube diameters to suit a variety of applications. Featuring ARC (Automate Radio Communication), the 18mm R-Series Automate system provides an intelligent Li-ion battery, or a DC powered solution.

AESTHETIC FEATURES

- Slim motor head for minimal light gap

ASSEMBLY / PRODUCTION FEATURES

- Crown, drive and adapters available to suit two tube sizes

FUNCTIONAL BENEFITS

- Leveling control
- Simple limit setting and adjustment
- Favorite position
- 3 operational speed settings
- 2-way RF communication
- ARC protocol for simple programming

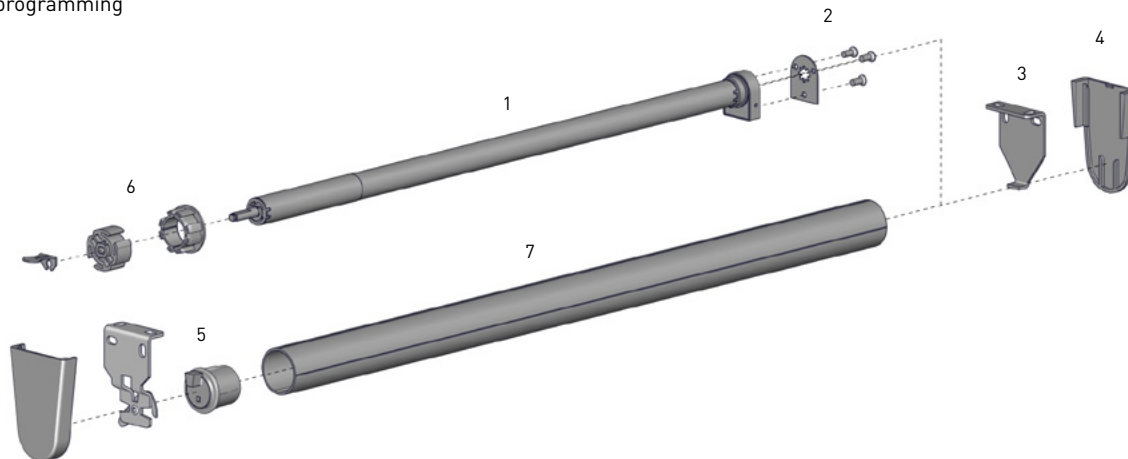

SYSTEM INDEX

1	Automate Motor 18mm MTDCBRF18-0.2 - Li-ion 0.2 MTDCRF18-0.2 - Li-ion 0.2
2	Motor Adapter MTAD-18-RS
3	R-Series Brackets RB360xx - R8 1½" Set RB380xx - R8 2" Set RB390xx - R8 2-½" Set
4	R-Series Bracket Covers RBPC360xx RBPC380xx
5	Pin End REP01xx - 1½" tube REP02xx - 1" tube
6	Crown and Drive Kit MTCRDR-25-1 - 1" tube MTCRDR-25-1.125 - 1½" tube
7	Aluminum Tube RTEA1T## - 1" tube RTEA2T## - 1½" tube

- Size
xxx= Color

COLOR RANGE

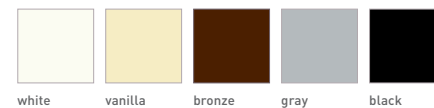

SYSTEM UPGRADES

- CASSETTE 80/100/120
- FASCIA 3"/4"/5"
- LINK SYSTEM
- POCKETS 3"/4"/5"/6"

CONTROL OPTIONS

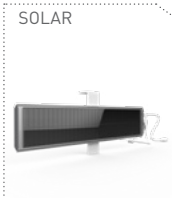

PRODUCT OPTIONS



SPECIFICATIONS

DEDUCTION CHART

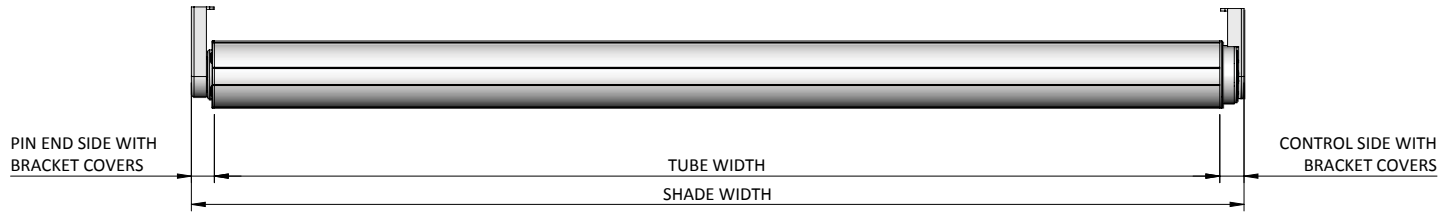

MOTOR	TUBE	BRACKETS	LIGHT GAP			MINIMUM SHADE WIDTH	
			CONTROL END	PIN END	OVERALL		
MTDCBRF18-0.2/ MTCRF18-0.2	1" OR 1 1/8"	With Covers	0.63" [16mm]	0.71" [18mm]	1.34" [34mm]	MTDCBRF18-0.2	1.80' [0.550m]
		No Covers	0.55" [14mm]	0.63" [16mm]	1.18" [30mm]	MTCRF18-0.2	1.31' [0.400m]

MAX ROLL

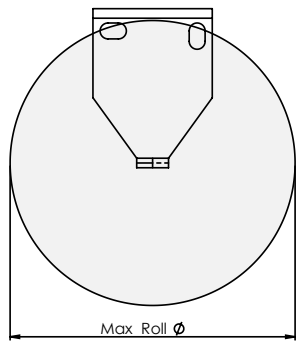

BRACKET	MAX ROLL SIZE
RB360xx	2.57" [69mm]
RB380xx	3.65" [92mm]
RB390xx	4.00" [101mm]

TUBE SPECS.

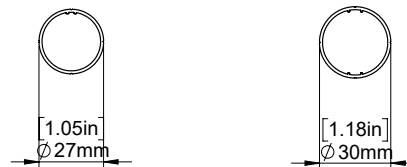

1" Tube

Code: RTEA1T12

Length 12'
[3.66m]

1 1/8" Tube

Code: RTEA2T16

Length 16'
[4.88m]

1" TUBE		1 1/8" TUBE	
Ø WIDTH	MAX DROP	Ø WIDTH	MAX DROP
5.91' [1.80m]	1.31' [0.40m]*	6.56' [2.00m]	1.31' [0.40m]*
1.97' [0.60m]	9.84' [3.00m]*	1.97' [0.60m]	9.84' [3.00m]*

* Recommended Max Drop. Exceeding this value may cause fabric tracking issues

SYSTEM CAPACITY

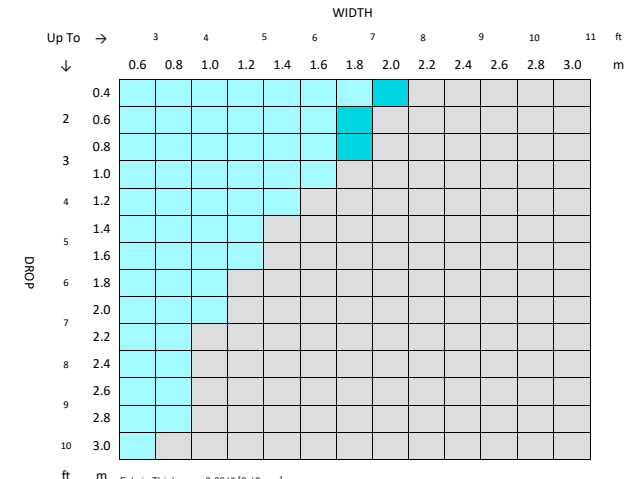

Fabric Thickness: 0.024" [0.60mm]
Fabric Density: 12.39oz/yd² [420gsm]
Weight Bar: D30 Silent Medium Aluminium Bottom Rail

CONTROL	TUBE
18mm Motor	RTEA1T## - 1"
	RETA2T## - 1.125"
	OUTSIDE SPECIFICATIONS