

**S45 AUTOMATE 3.0Nm | 35mm | 12V**

The motorized S45 roller shade system offers a range of four Automate motors with three tube diameters to suit a variety of applications. Featuring ARC (Automate Radio Communication), the 35mm S45 Automate system provides an intelligent, Li-ion battery or DC powered solution.

**AESTHETICAL FEATURES**

- Slim and compact roller shade system
- Contemporary design

**PRODUCT FEATURES**

- Easy-Lock effortless installation
- Easy limit setting and programming

**FUNCTIONAL FEATURES**

- Levelling control
- Simple limit setting and adjustment
- Favorite position
- 3 operational speed settings
- 2-way RF communication
- ARC protocol for simple programming

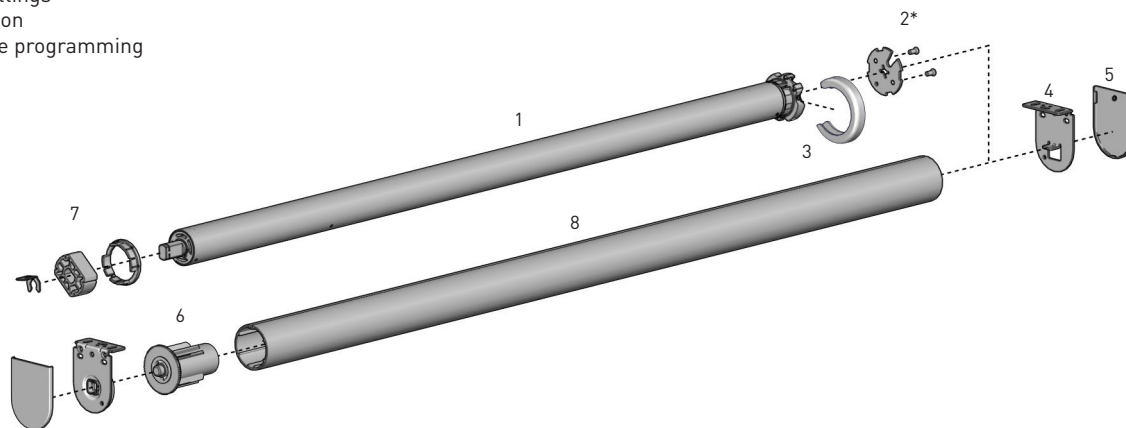

**SYSTEM INDEX**

1	Automate Wirefree Motor MTDCBRF35-3 - Li-ion Q3.0 MTDCRF35-3 - DCRF 3.0 MTACRF35-6 - ACRF 6 MTACQRF35-6 - ACRF Q6
3	Motor Cap MTCAP35xx
2	Brackets RB40-8355-xxx040 RB40-9355-xxx040
5	Bracket Covers RB08-4151-xxx040
6	Pin End RB09-0245-xxx001
7	Crown & Drive Set MTCRDR-35-S45
8	T-Spline Aluminum Tubes RB93-044#-000490 RB93-644#-000490
9	Adaptor RB40-1402-069400
10	Screws for Adaptor SLAMSCREW

# - Size  
xxx= Color

**COLOUR RANGE**



**SYSTEM UPGRADES**

- CF90 CASSETTE
- CF90 EDGE
- LINK SYSTEM

**CONTROL OPTIONS**

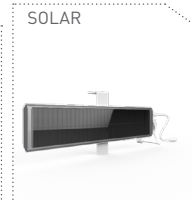
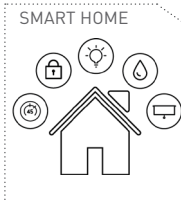

**PRODUCT OPTIONS**



**SPECIFICATIONS**

**SYSTEM CAPACITY**

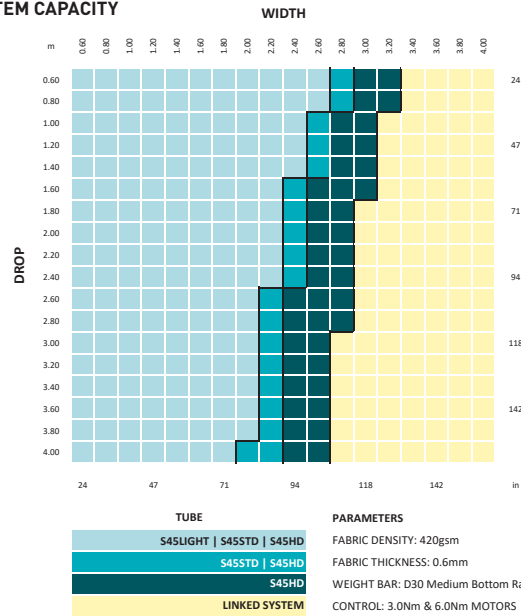

**DEDUCTION CHART**

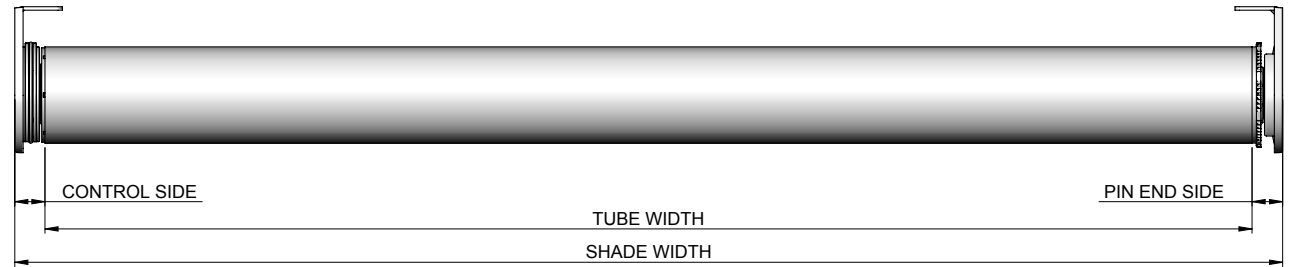

MOTOR	MINIMUM SHADE WIDTH
MTDCBRF35-3	0.800m [2.60']
MTDCRF35-3	0.600m [2.00']
MTACRF35-6	0.730m [2.40']
MTACQRF35-6	0.700m [2.30']

MOTOR	BRACKETS	LIGHT GAP		TUBE DEDUCTION
		CONTROL END	PIN END	
MTDCBRF35-3 MTDCRF35-3 MTACRF35-6 MTACQRF35-6	With Covers	17mm [0.67"]	14mm [0.55"]	31mm [1.22"]
	No Covers	16mm [0.63"]	13mm [0.51"]	29mm [1.14"]

TUBE DEDUCTION = SHADE WIDTH - (CONTROL LIGHT GAP + PIN END LIGHT GAP)

**MAX ROLL**

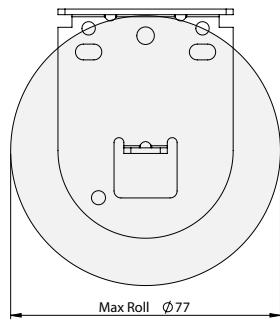

BRACKET	MAX ROLL SIZE
RB09-8355-xxx040	77mm [3.03"]
RB09-9355-xxx040	77mm [3.03"]

**TUBE SPECS.**

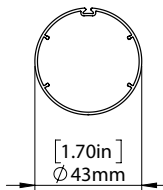

**S45 Light Tube**  
 Code RB93-0443-000490  
 w. tape RB93-6443-000490  
 Length 16' [4.88m]

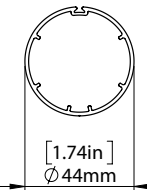

**S45 STD Tube**  
 Code RB93-0444-000490  
 w. tape RB93-6444-000490  
 Length 16' [4.88m]

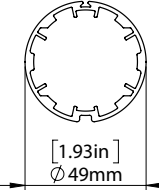

**S45 HD Tube**  
 Code RB93-0449-000490  
 w. tape RB93-6449-000490  
 Length 16' [4.88m]

MOTOR	MAX LIFTING CAPACITY			MAX DROP**
	S45 LT	S45 STD	S45 HD	S45
3.0Nm	14.1kg [31.1lbs]	13.8kg [30.4lbs]	12.5kg [27.6lbs]	4m [3.28']
6.0Nm	28.3kg [62.4lbs]	27.7kg [61.1lbs]	25.0kg [55.1lbs]	4m [3.28']

Exceeding these values may cause fabric tracking issues