

AUTOMATE A.R.T. WIND / LIGHT SENSOR INSTRUCTIONS

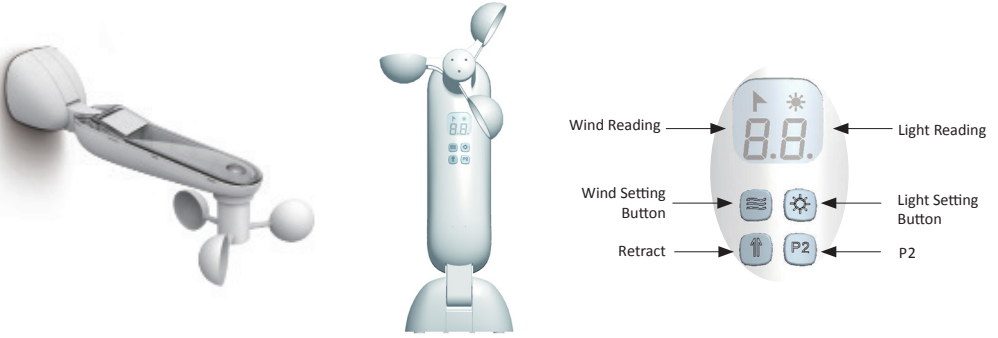

AUTOMATE A.R.T |
Solar Powered Wind & Light Sensor
Part #: RB24-9300-069002

DESCRIPTION



- A.R.T. (AUTOMATE REACTIVE TECHNOLOGY) Solar powered Wind & Light sensor with built in Lithium Ion Battery.
- Compatible with AUTOMATE motors and controllers.
- Suitable for monitoring Wind & light intensity and reacting according to pre selected settings to control motorised awnings or external blinds
- 3 x Wind speed sensitivities.
- 4x Light intensity levels.

CONTENTS

- Wind & Light Sensor
- Fixing screws
- Instruction Manual

TECHNICAL SPECIFICATIONS	
Voltage:	3V
Frequency:	433MHz
Transmitting Power:	10 milliwatt
Operating Temperature:	-5°C - 60°C
Transmission Distance:	up to 200 meters (open space)



INSTR.RB24-9003-069002_JULY 2016

CONTENTS

Pairing with primary remote	p3
Adjusting Wind & Light levels	p3

COMPATIBLE PRIMARY REMOTES

RF500s



RF400s



INSTALLATION POSITIONS

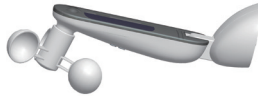

CAUTION

Do not allow children to play with this device or battery.
Use or modification outside the scope of this instruction manual will void warranty.

DISPOSAL



Do not dispose of in general waste. Please recycle batteries and damaged electrical products appropriately.

PAIRING WITH PRIMARY REMOTE

using primary RF500

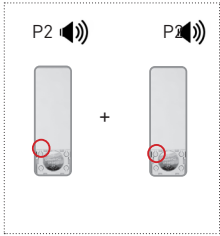

OR

using primary RF401 single channel / timer remote

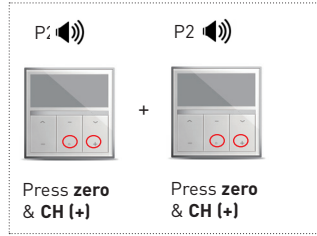

OR

using primary RF415 fifteen channel remote

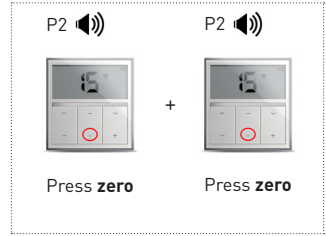

Ensure primary remote has already been paired with motor.

within 6 seconds



On Multi Channel remote ensure desired channel is active first.

P2

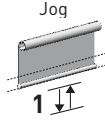

ADJUSTING WIND & LIGHT LEVELS

Hold **Wind** or **Light** Button for 3sec

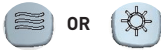

Icon Flashes

Toggle to desired setting by pressing the same button.



After 10 seconds setting will automatically be set and the display times out.

LIGHT LEVEL FOR OPEN COMMAND	
0	Inactive
1	15kLUX
2	25kLUX
3	45kLUX
4	60kLUX

WIND-SPEED LEVEL FOR CLOSE COMMAND	
0	Inactive
1	15km/h
2	25km/h
3	45km/h



3 X QUICK PRESS

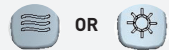

Displays live wind speed (km/h) or Light reading (kLUX)

TROUBLESHOOTING

PROBLEM	CAUSE	REMEDY
Motor is not responding	Transmitter battery is discharged	Replace battery
	Battery is inserted incorrectly	Check battery polarity
	Radio interference / Shielding	Ensure transmitter is positioned away from metal objects and that aerial on motor or receiver is kept straight and away from metal.
	Receiver distance is too far from transmitter	move transmitter to a closer position.
	Power failure	Check power supply to motor is connected and active.
	Incorrect wiring	Check wiring is connected correctly (refer to motor installation instructions)
	Pairing error	Press retract button on sensor to verify pairing.
Awning extends then constantly retracts unexpectedly	Wind of light Sensitivity set too high	reduce sensitivity
	extended awning is casting shadow onto sensor	check & reposition sensor if necessary.
Awning does not react to wind or light setting	Wind Sensitivity is too high or too low	adjust sensitivity
	Duration of wind intensity level is less than 3 seconds	wind gust durations must be over 3 seconds to trigger.
	Duration of light intensity level is less than 6 min	Duration of set light intensity level must be sustained for greater than 6 min



How to delete all transmitters & limits. P2 + STOP + P2.

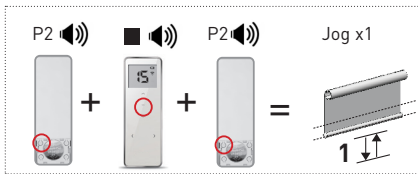

ROLLEASE ACMEDA AUSTRALIA

110 Northcorp Boulevard,
Broadmeadows VIC 3047

T +61 3 9355 0100 | F +61 3 9355 0110

Western Australia Branch
Unit 1, 41 Mulgool Road,
Malaga WA 6090

T +61 8 9248 5571 | F +61 8 9248 5572

Queensland Branch
Unit 2/62 Borthwick Avenue,
Murarrie QLD 4172

ROLLEASE ACMEDA USA

200 Harvard Avenue
Stamford, CT 06902 6320

T +1 203 964 1573 | F +1 203 964 0513

ROLLEASE ACMEDA EUROPE

Via Conca Del Naviglio 18, Milan
(Lombardia) Italy

T +39 02 8982 7317 | F +39 02 8982 7317

info@rolleaseacmeda.com
rolleaseacmeda.com