

AUTOMATE™

5V Zero Li-ion EQ 1.1

The rechargeable, battery-powered motor for small to medium shades in residential and small commercial projects.



PATENTED MOTOR HEAD DESIGN
Offers the smallest light-gap and antenna cable can be concealed within the motor head.



INNOVATIVE MOTOR CAP
Optional, custom-designed accessory for no visible wires.



EXTRA QUIET
Variable speed and soft-stop function makes this the quietest Automate motor yet.



ELEGANT SOFT STOP
Slows the motor down for a smooth stop to prevent damage to the shade, and preserves the life of the battery.



BATTERY CHECK ACTION
When paired with Push5 remote, motor will move shade to indicate battery percentage.



MICRO USB CHARGING
Custom motor charger not required. Utilize any micro USB cable and charger to renew battery.



SECURE HOLD
Motor head design accommodates bracket with a 12mm tongue for a more secure fit.



SIMPLIFIED RETROFIT
Upgrade manual or motorized shade systems seamlessly to maintain existing deductions, achieve minimal light gap, and eliminate bracket adjustments.



5 YEAR WARRANTY



ARC™ (Automate Radio Communication) is Rollease Acmeda's proprietary technology utilizing 433MHz radio communication with bi-directional feedback that brings Automate motorized shading systems together.

© Rollease Acmeda

PRODUCT SPECIFICATIONS

Singles:

Part #: MT01-1325-069001 5V LI-ION MOTOR Short
[1.1N Ø25/5V/20rpm](SKY)

Part #: MT01-1325-069002 5V LI-ION MOTOR
[1.1N Ø25/5V/20rpm](SKY)

Cartons:

Part #: MT01-1325-069012 5V LI-ION MOTOR Short CT
[1.1N Ø25/5V/20rpm](SKY)

Part #: MT01-1325-069013 5V LI-ION MOTOR CT
[1.1N Ø25/5V/20rpm](SKY)

Voltage	5V-DC	Limit Switch Type	Electronic
Torque	1.1Nm	Current	0.83 A
Max Run Time	12 min.	Battery Size/Type	2600mAH
Speed	20 RPM (Adjustable to 24 or 28)	Temp Working Range	32°F to 140°F (0°C to 60°C)
Radio Frequency	433.92 MHz	Insulation Class	III
RF Modulation	FSK	Sound Level	~46 dB
IP Rating	IP20	Power	10 W

COMPATIBLE TUBES

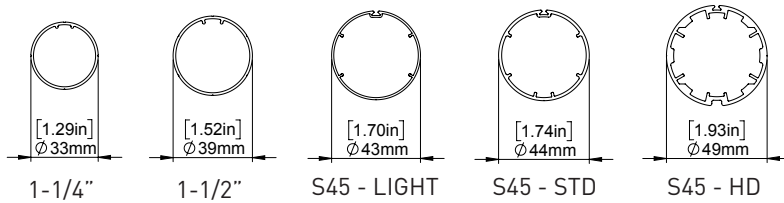

APPLICATIONS

- Roller Shades
- Roman Shades

DIMENSIONS

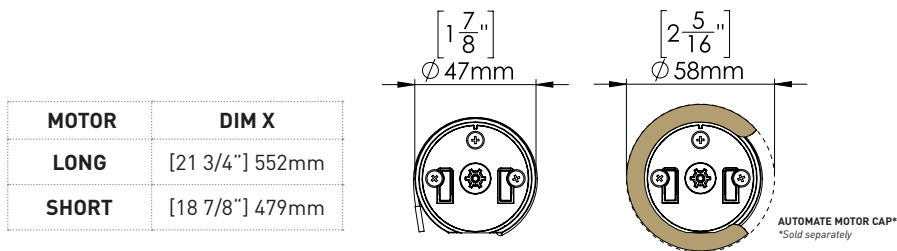
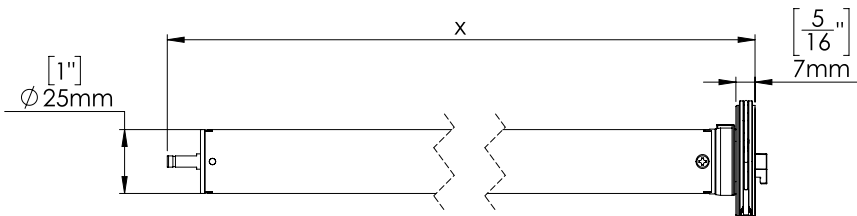

MOTOR	DIM X
LONG	[21 3/4"] 552mm
SHORT	[18 7/8"] 479mm

MOTAR HEAD ADAPTORS

- MT03-0205-069001 AUTOMATE I BRACKET ADAPTOR R8 SERIES
- MT03-0205-069002 AUTOMATE I BRACKET ADAPTOR R16-SERIES
- MT03-0206-069002 AUTOMATE I BRACKET ADAPTOR SKYLINE SERIES

COMPATIBLE PRODUCTS (refer to catalog for full item listings)

Controllers



Charging Options

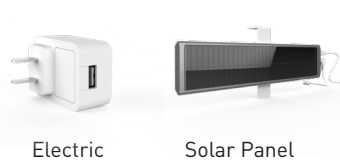

Motor Cap



Sensors

